



Pinsent Masons

**WHO DARES, BIMs or  
Handling BIM Risk in Hong Kong**

The Chartered Institution of Civil  
Engineering Surveyors  
31 July 2013



# Who Dares, BIMs

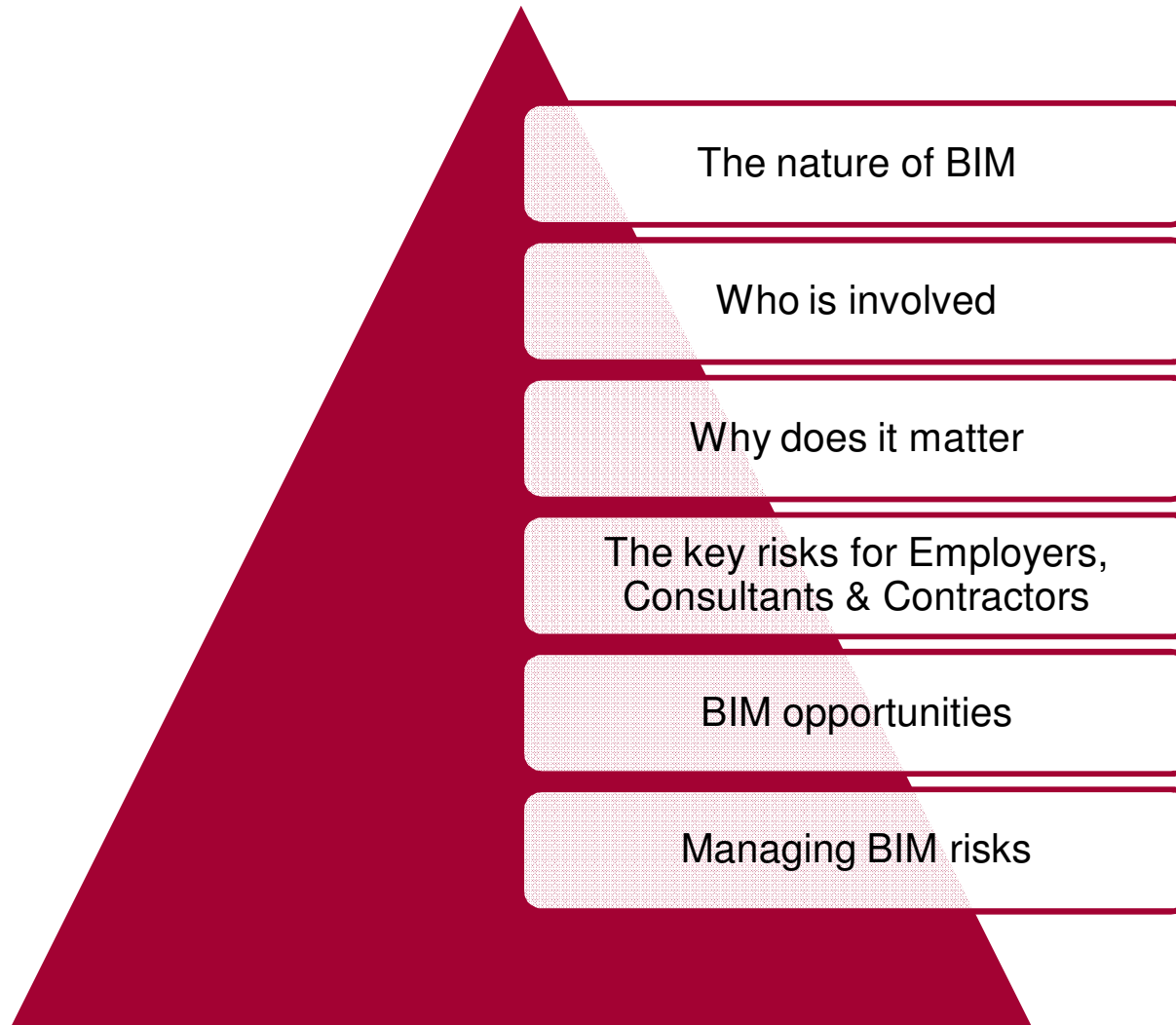

# What is BIM?

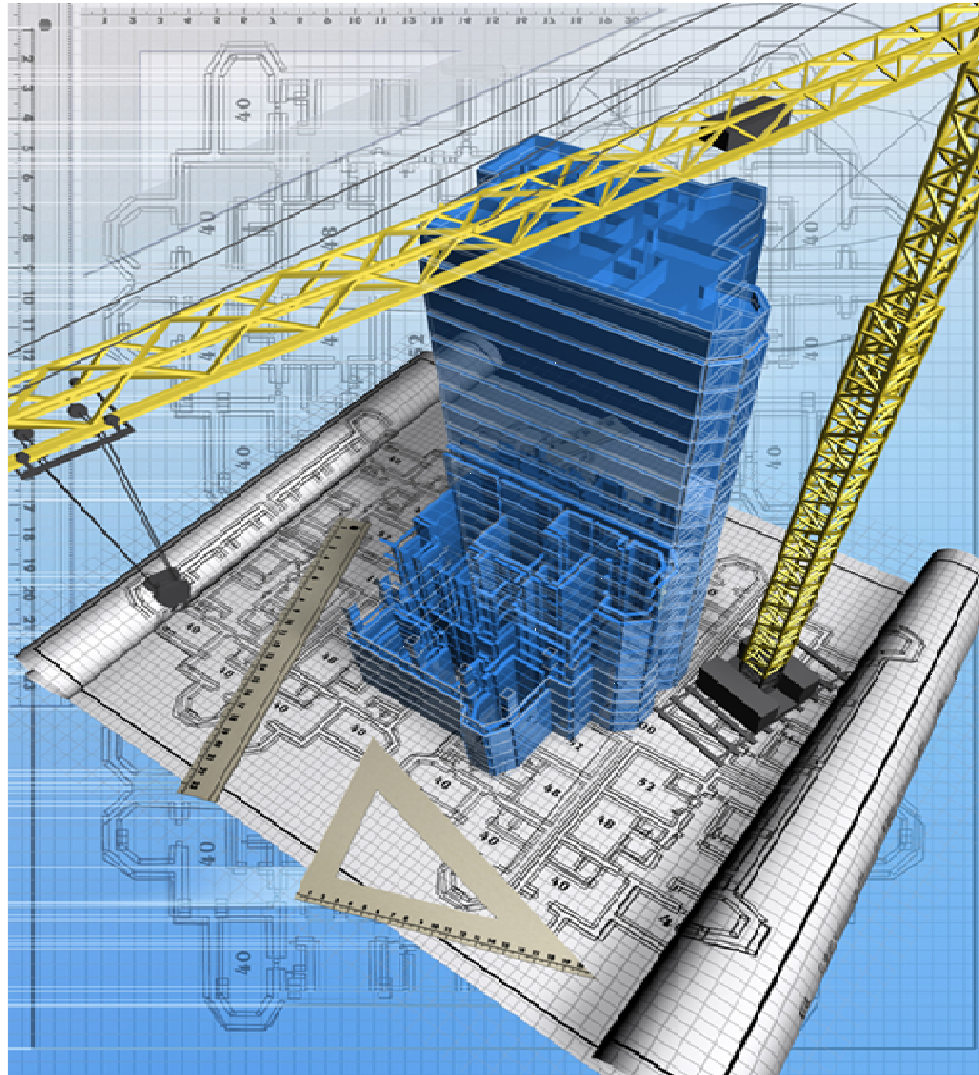

# What is BIM?

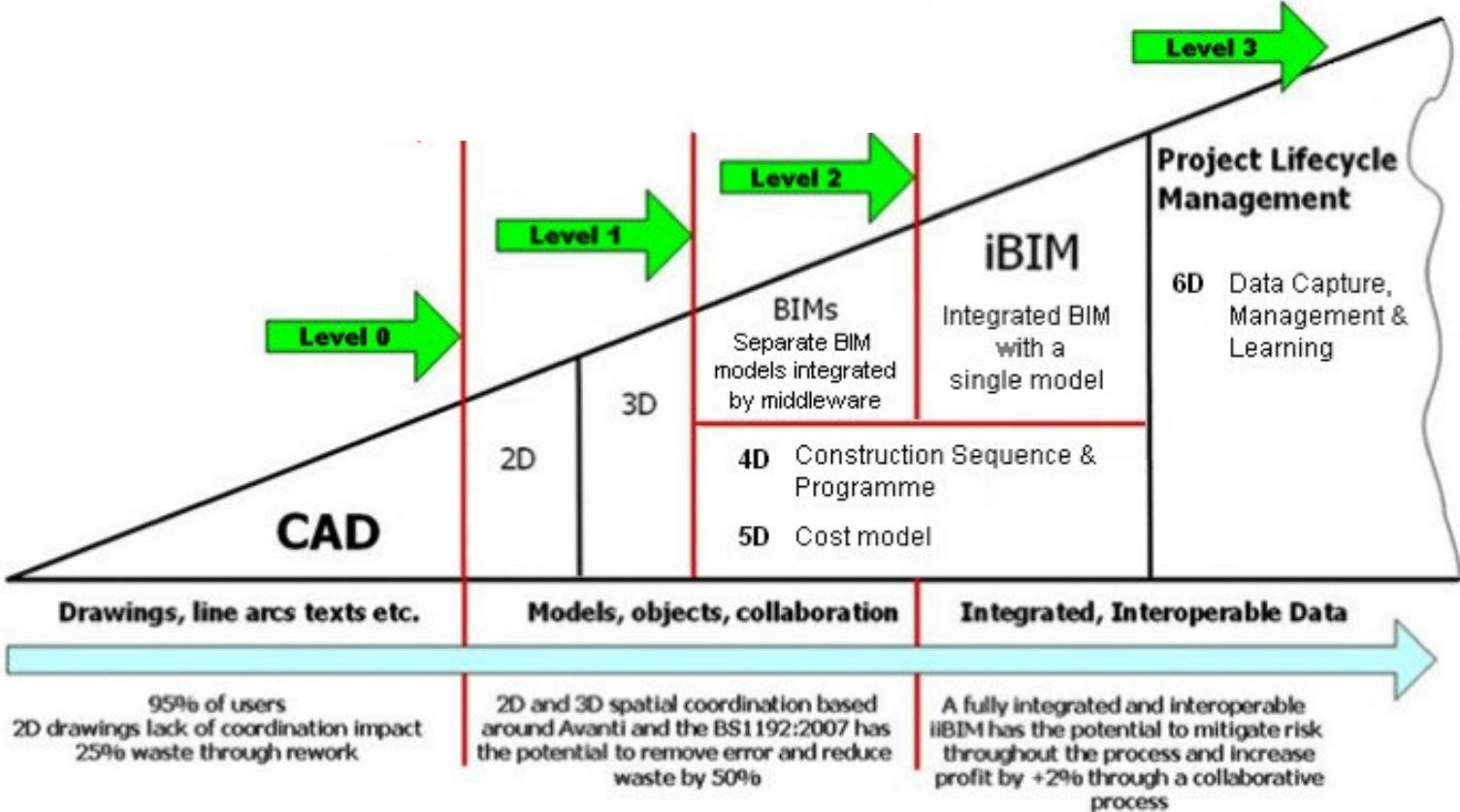

Based on a diagram created by Mark Bew of BuildingSmart and Mervyn Richards of CPIC (2008)

# What is BIM?

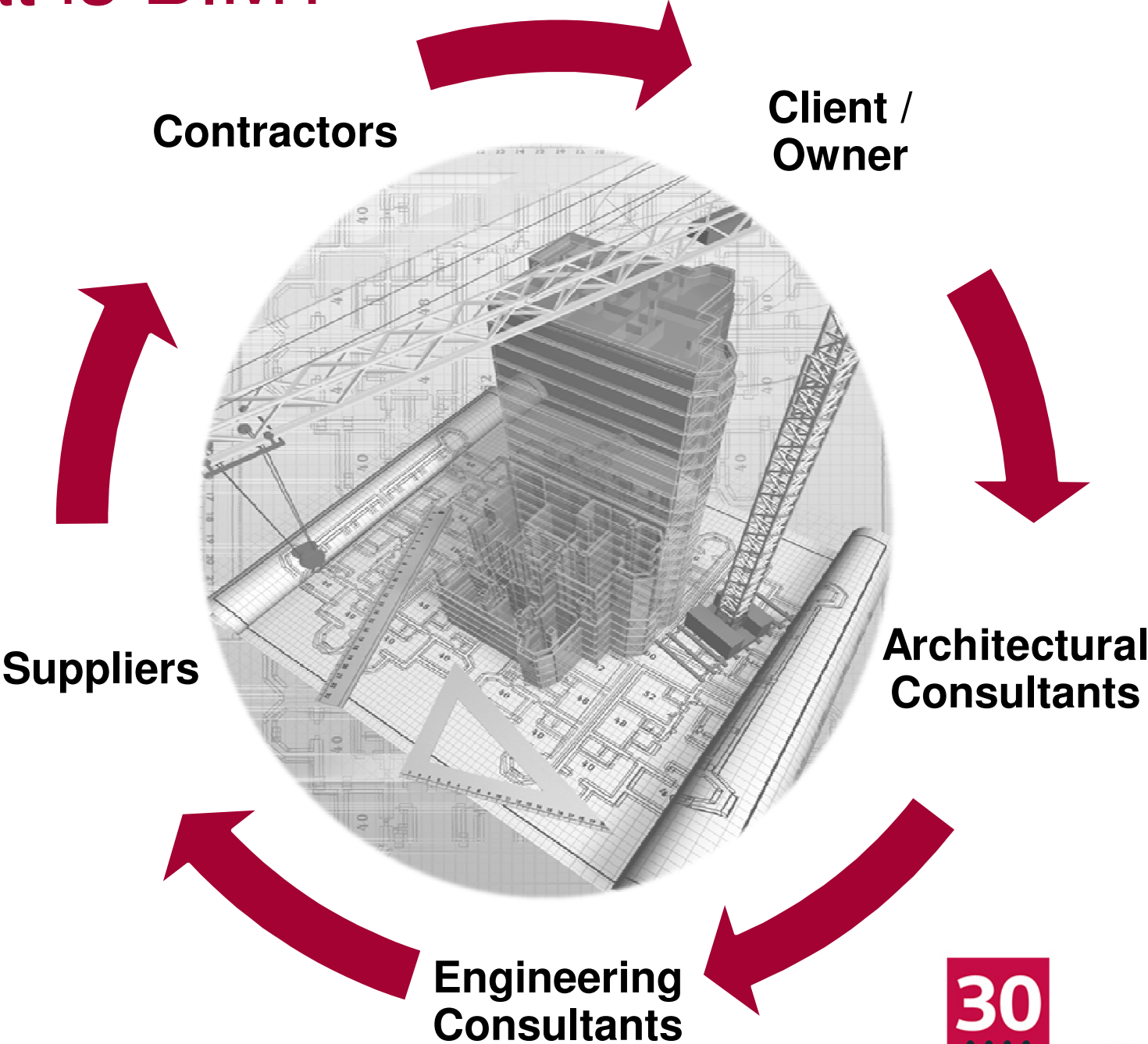

# What is BIM?

## Purposes

- Tender
- D&B
- O&M

## Misconceptions

- BIM is not just about the number of dimensions
- BIM is not a visual model

# Who BIMs?

Public Sector – aspiration

Private Sector – progress

Supporting BIM

- HKIBIM
- buildingSMART
- CIC
- HKCA: Vision 2020

International adoption

# Why get involved in BIM?

## Challenges for infrastructure sector

- Keen competition
- Increasingly sophisticated projects
- Shorter times to complete

## BIM is a technological solution

- Increase efficiency
- Manage projects: costs and time
- Develop brand value



# Why get involved in BIM?

Some differing perspectives among contracting parties:

- Employers
- Consultants
- Contractors

Key drivers for BIM adoption

Different perspectives among leading countries

# BIM between Employer & Consultant

Duty of Care

Ownership

Intellectual Property

Insurance

# BIM: Consultants and Sub-Consultants

Professional terms of engagement

Information and reliance

Different BIM models

Duplication and the risk of ambiguity

# BIM: Employer and Contractors

Design Responsibility

Standard of care

Model Uptime

Information & Reliance

Coordination & Amendment of the BIM

# BIM: Consultants and Contractors

Information & Reliance

Types of Information

Responsibility for inputs

# BIM: Employer and Contractors



# BIM: Employer and Contractors

## Issues

- Design obligation
- Risk of being in control of the BIM
- Safety in relying on others' information
- Resolving conflicts and clashes
- For how long does the duty to check endure?

# BIM: Third Party/Contractors/Employer





# BIM: Third Party/Contractors/Employer

## Issues

- Liability to the Employer
- Liability to the purchasers

## Third Party liability post-BIM

- *Hedley Byrne v Heller & Partners*
- *D&F Estates v Church Commissioners*
- *Robinson v PE Jones*

# Realising BIM Opportunities

## Embrace the change

- Plan the BIM Transition
- Identify existing BIM obligations

## Seize the chance

- Reduce costs & Increase efficiency
- Deliver projects on time and on budget
- Practice using the BIM process

## Differentiate yourself

- New BIM capabilities
- New client expectations
- New added value

# Handling BIM Risks





Pinsent Masons LLP is a limited liability partnership registered in England & Wales (registered number: OC333653) authorised and regulated by the Solicitors Regulation Authority, and by the appropriate regulatory body in the other jurisdictions in which it operates. The word 'partner', used in relation to the LLP, refers to a member of the LLP or an employee or consultant of the LLP or any affiliated firm of equivalent standing. A list of the members of the LLP, and of those non-members who are designated as partners, is displayed at the LLP's registered office: 30 Crown Place, London EC2A 4ES, United Kingdom. We use 'Pinsent Masons' to refer to Pinsent Masons LLP and affiliated entities that practise under the name 'Pinsent Masons' or a name that incorporates those words. Reference to 'Pinsent Masons' is to Pinsent Masons LLP and/or one or more of those affiliated entities as the context requires. © Pinsent Masons LLP 2013

For a full list of our locations around the globe please visit our websites:



[www.pinsentmasons.com/asia](http://www.pinsentmasons.com/asia)



[www.Out-Law.com](http://www.Out-Law.com)